

CHIA-MO

WWW.CHIAMO.IT

I T A L Y

CONTROPUNTE ROTANTI PER TORNI

LIVE CENTRES FOR LATHES



CONTROPUNTE ROTANTI PER TORNI

LIVE CENTRES FOR LATHES

Le contropunte rotanti vengono impiegate principalmente per lavori di tornitura su tutti i tipi di tornio con un utilizzo di giri medio/alto. Sono progettate per l'alloggiamento di cuscinetti radiali ed assiali di alta qualità su sedi rettificate e si differenziano in 3 tipologie di grandezza con diametro esterno 32, 43 e 58 per lavorazioni con carichi più o meno elevati. I modelli 172300, 172400 e 172600 sono tutti dotati di cuspidi intercambiabile per facilitare il cambio della punta in caso di usura e in caso di lavorazioni di particolari diversi. Possono essere fornite con attacco cono morse, attacco cilindrico metrico e in pollici e attacco Vdi.

Descrizione e specifiche

Le contropunte rotanti sono costruite con acciaio certificato altamente legato, sono temprate e completamente rettificate. Tutto il ciclo produttivo viene svolto nel nostro stabilimento in Italia con macchine utensili di alta precisione ed è rigorosamente controllato. Grazie all'ampia disponibilità di magazzino possiamo generalmente spedire il materiale il giorno stesso della ricezione dell'ordine.

Maggiori informazioni

Oltre alla serie standard produciamo contropunte rotanti progettate con compensazione assiale grazie all'alloggiamento di una serie di molle a tazza montate all'interno del corpo contropunta. Questa compensazione le rende adatte, oltre all'utilizzo standard sulla contropunta, ad essere montate su supporti statici come per esempio il contro-mandrino del tornio, una seconda torretta del tornio ecc...

Prodotti

Contropunte rotanti per torni - Contropunte con cuspidi intercambiabile - Contropunte con compressione - Contropunte con attacco cono morse, con attacco cilindrico, con attacco Vdi DIN 69880.

The live centers are mainly used for turning on all types of lathe with a medium / high r.p.m. use. They are designed to be assembled with radial and axial high quality bearings. They are manufactured in 3 types of size with outer diameter 32, 43 and 58 for machining with more or less high load. The models 172300, 172400 and 172600 are all equipped with interchangeable center to facilitate changing of the tip in case of wear and in case of workings of different details. They can be supplied with vice taper fitting, metric and inch cylindrical shaft fitting and Vdi fitting.

Description and Specifications

The live centers are produced with certified top quality steel, they are hardened and completely grinded. All production cycle is carried out in our factory in Italy with high precision machines and is carefully controlled. Thanks to the availability of stock, we can usually ship the material the same day as order is received.

Further Information

In addition to standard series we produce live centers designed with axial compensation thanks to the housing of a series of cup springs mounted into body tailstock. This compensation makes them suitable, in addition to using on the standard tailstock, to be assembled on supports static such as the counter-spindle of the lathe, a second turret of the lathe etc ...

Products

Revolving live centers for lathe - Live centers with interchangeable insert - Plug-in live centers - Live centers with Vdi DIN 69880 fitting, with vice taper fitting, with cylindrical fitting.



CONTROPUNTA ROTANTE CON COMPRESSIONE Tipo 172200

REVOLVING TAILSTOCK WITH COMPRESSION

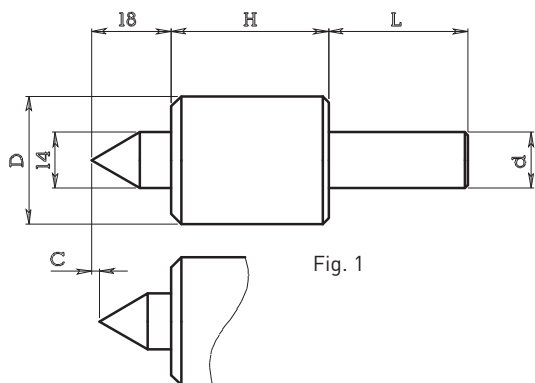
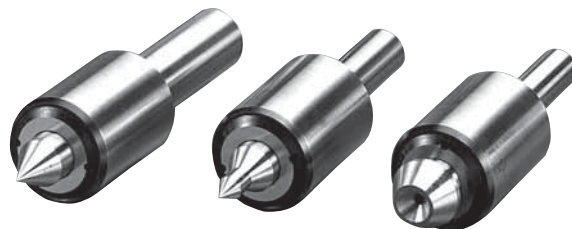

Fig. 1

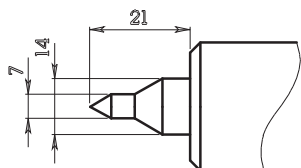

Fig. 2

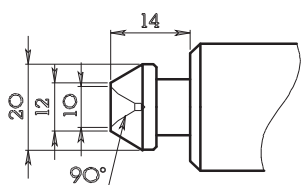

Fig. 3

C = Corsa di compressione
C = Absorber stroke

ATTACCO CILINDRICO (Cylindrical fitting)

Art. / Code			d	D	H	L	C	Punta / Center
Fig. 1	Fig. 2	Fig. 3						
172.208 F1	172.208 F2	172.208 F3	8	32	39.5	35	2	60°
172.210 F1	172.210 F2	172.210 F3	10	32	39.5	35	2	60°
172.212 F1	172.212 F2	172.212 F3	12	32	39.5	35	2	60°
172.214 F1	172.214 F2	172.214 F3	14	32	39.5	35	2	60°
172.215 F1	172.215 F2	172.215 F3	15.875	32	39.5	35	2	60°
172.216 F1	172.216 F2	172.216 F3	16	32	39.5	35	2	60°
172.219 F1	172.219 F2	172.219 F3	19.05	32	39.5	46	2	60°
172.220 F1	172.220 F2	172.220 F3	20	32	39.5	46	2	60°
172.222 F1	172.222 F2	172.222 F3	22	32	39.5	46	2	60°
172.225 F1	172.225 F2	172.225 F3	25	32	39.5	46	2	60°
172.226 F1	172.226 F2	172.226 F3	25,40	32	39.5	46	2	60°

ATTACCO CONO MORSE (Morse taper fitting)

Art. / Code			d	D	H	L	C	Punta / Center
Fig. 1	Fig. 2	Fig. 3						
172.202 F1	172.202 F2	172.202 F3	C.M2	32	39.5	69	2	60°

CONTROPUNTA ROTANTE CON COMPRESSIONE Tipo 172300

REVOLVING TAILSTOCK WITH COMPRESSION

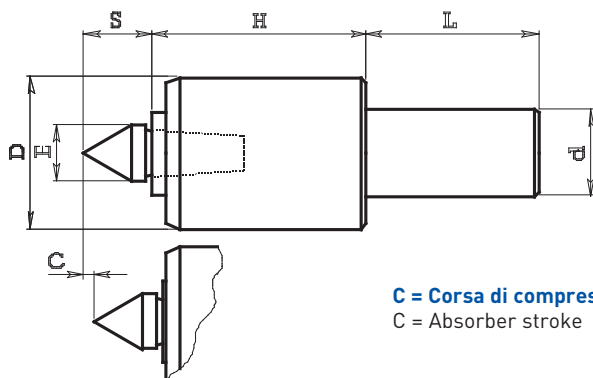
C = Corsa di compressione
 C = Absorber stroke

ATTACCO CILINDRICO (Cylindrical fitting)

Art. / Code	d	D	E	H	L	S	C
172.308	8	32	14	44	35	16	2
172.310	10	32	14	44	35	16	2
172.312	12	32	14	44	35	16	2
172.314	14	32	14	44	35	16	2
172.315	15.875	32	14	44	35	16	2
172.316	16	32	14	44	35	16	2
172.319	19.05	32	14	44	46	16	2
172.320	20	32	14	44	46	16	2
172.322	22	32	14	44	46	16	2
172.325	25	32	14	44	46	16	2
172.326	25.40	32	14	44	46	16	2

ATTACCO CONO MORSE (Morse taper fitting)

Art. / Code	d	D	E	H	L	S	C
172.300 CM2	C.M.2	32	14	44	69	16	2

La contropunta viene fornita con cuspidi art. 172.301 (salvo diversa identificazione)

The revolving tailstock is provided with code 172.301 (interchangeable insert)

CUSPIDI INTERCAMBIABILI PER CONTROPUNTA

INTERCHANGEABLE INSERT

Per articolo (for Code): 172.300

Art. / Code	Fig.	E	S	G	F	Punta / Center
172.301	1	14	16	-	-	60°
172.301 090	1	14	22	-	-	90°
172.302	2	14	22	7	-	60°
172.302B	2	14	26	8	-	60°
172.303	3	20	12	12	10	60°

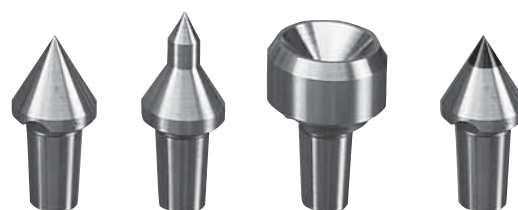
CON METALLO DURO (With hard metal)

Art. / Code	Fig.	E	S	G	F	Punta / Center
172.301 HM	4	14	16	6	-	60°

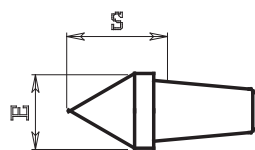

Fig. 1

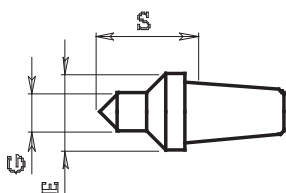

Fig. 2

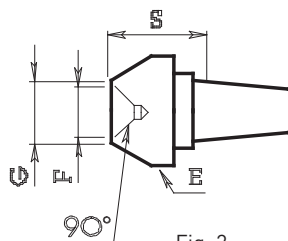

Fig. 3

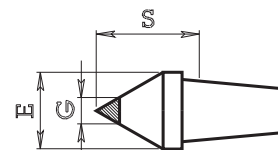
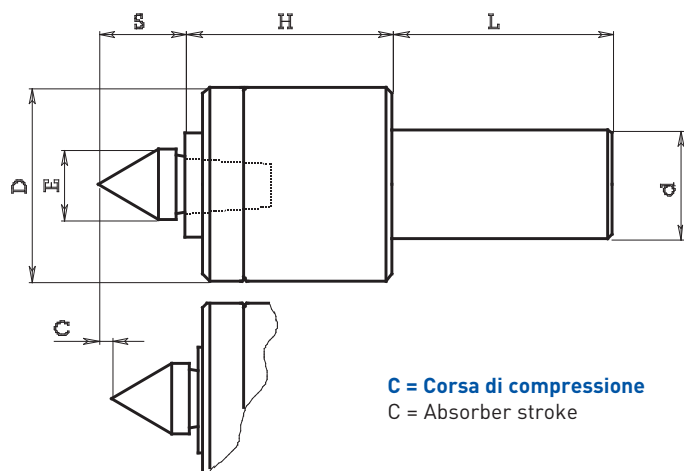

Fig. 4

CONTROPUNTA ROTANTE CON COMPRESSIONE Tipo 172400

REVOLVING TAILSTOCK WITH COMPRESSION



C = Corsa di compressione
C = Absorber stroke



ATTACCO CILINDRICO (Cylindrical fitting)

Art. / Code	d	D	E	H	L	S	C
172.419	19.05	43	18	43	46	21	3
172.420	20	43	18	43	46	21	3
172.422	22	43	18	43	46	21	3
172.425	25	43	18	43	46	21	3
172.426	25.40	43	18	43	46	21	3
172.430	30	43	18	43	46	21	3
172.431	31.75	43	18	43	46	21	3
172.432	32	43	18	43	46	21	3

ATTACCO CONO MORSE (Morse taper fitting)

Art. / Code	d	D	E	H	L	S	C
172.400 CM2	C.M.2	43	18	43	69	21	3
172.400 CM3	C.M.3	43	18	43	85	21	3

La contropunta viene fornita con cuspidi art. 172.401 (salvo diversa richiesta)
The revolving tailstock is provided with code 172.401 (interchangeable insert)

CHIAVI PER ESTRAZIONE CUSPIDI ART. 172.411
PULLER CODE 172.411

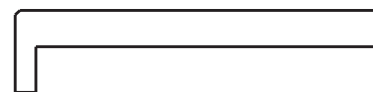

CUSPIDI INTERCambiabili PER CONTROPUNTA

INTERCHANGEABLE INSERT

Per articolo (for Code): 172.400

Art. / Code	Fig.	E	S	G	Punta / Center
172.401	1	18	21	—	60°
172.401 090	1	18	28	—	90°
172.402	2	18	27	7	60°
172.402B	2	18	38	9	60°
172.403	3	30	21	14	60°
172.404	4	26	20	20	—



CON METALLO DURO (With hard metal)

Art. / Code	Fig.	E	S	G	Punta / Center
172.401 HM	5	18	21	6	60°

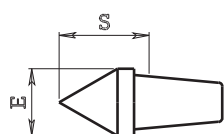

Fig. 1

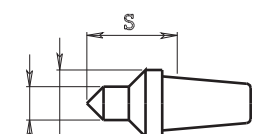

Fig. 2

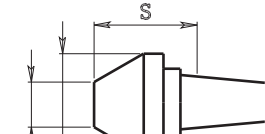

Fig. 3

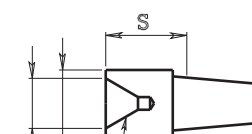

Fig. 4

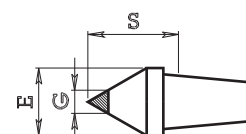
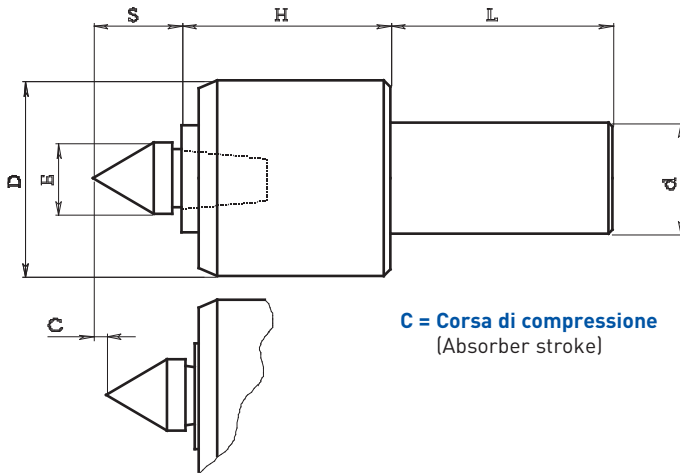

Fig. 5

CONTROPUNTA ROTANTE CON COMPRESSIONE Tipo 172600
 REVOLVING TAILSTOCK WITH COMPRESSION

C = Corsa di compressione
 (Absorber stroke)

ATTACCO CILINDRICO (Cylindrical fitting)

Art. / Code	d	D	E	H	L	S	C
172.625	25	58	28	71	50	34	2.5
172.626	25.40	58	28	71	50	34	2.5
172.632	32	58	28	71	70	34	2.5
172.640	40	58	28	71	85	34	2.5

ATTACCO CONO MORSE (Morse taper fitting)

Art. / Code	d	D	E	H	L	S	C
172.600 CM3	C.M.3	58	28	71	85	34	2.5
172.600 CM4	C.M.4	58	28	71	109	34	2.5
172.600 CM5	C.M.5	58	28	71	136	34	2.5

La contropunta viene fornita con cuspidi art. 172.601 (salvo diversa richiesta)
 The revolving tailstock is provided with code 172.601 (interchangeable insert)

CUSPIDI INTERCAMBIABILI PER CONTROPUNTA
 INTERCHANGEABLE INSERT

Per articolo (for Code): 172.600

Art. / Code	Fig.	E	S	G	Punta / Center
172.601	1	28	34	—	60°
172.602	2	28	40	7	60°
172.602B	2	28	40	12	60°
172.603	3	58	36	25	60°
172.604	4	28	32	24	—

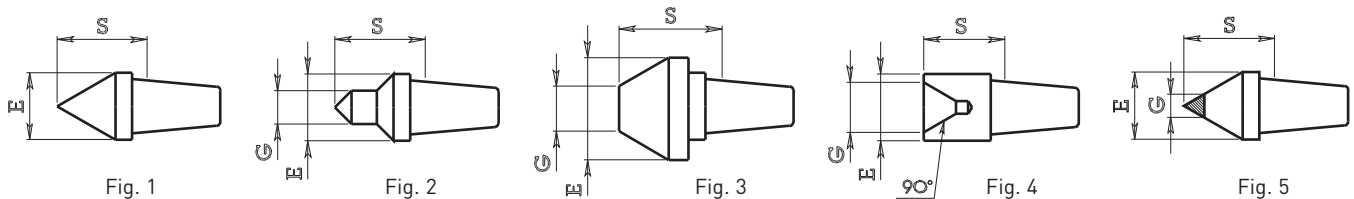

CON METALLO DURO (With hard metal)

Art. / Code	Fig.	E	S	G	Punta / Center
172.601 HM	5	28	34	10	60°

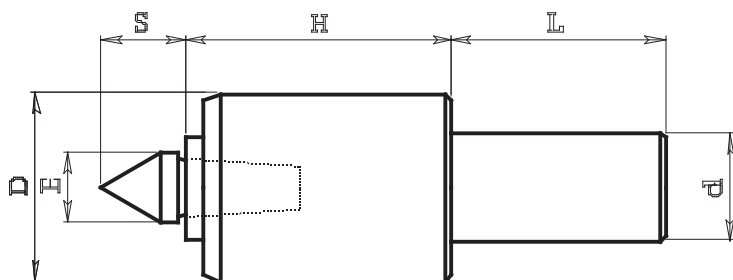

CONTROPUNTA ROTANTE Tipo 172300 F

REVOLVING TAILSTOCK



Senza compressione
(Without compression)

ATTACCO CILINDRICO (Cylindrical fitting)

Art. / Code	d	D	E	H	L	S
172.308 F	8	32	14	44	35	16
172.310 F	10	32	14	44	35	16
172.312 F	12	32	14	44	35	16
172.314 F	14	32	14	44	35	16
172.315 F	15.875	32	14	44	35	16
172.316 F	16	32	14	44	35	16
172.319 F	19.05	32	14	44	46	16
172.320 F	20	32	14	44	46	16
172.322 F	22	32	14	44	46	16
172.325 F	25	32	14	44	46	16
172.326 F	25.40	32	14	44	46	16

ATTACCO CONO MORSE (Morse taper fitting)

Art. / Code	d	D	E	H	L	S
172.300 F CM2	C.M.2	32	14	44	69	16

La contropunta viene fornita con cuspidi art. 172.301 (salvo diversa identificazione)

The revolving tailstock is provided with code 172.301 (interchangeable insert)

CUSPIDI INTERCambiabili PER CONTROPUNTA

INTERCHANGEABLE INSERT

Per articolo (for Code): 172.300

Art. / Code	Fig.	E	S	G	F	Punta / Center
172.301	1	14	16	-	-	60°
172.301 090	1	14	22	-	-	90°
172.302	2	14	22	7	-	60°
172.302B	2	14	26	8	-	60°
172.303	3	20	12	12	10	60°

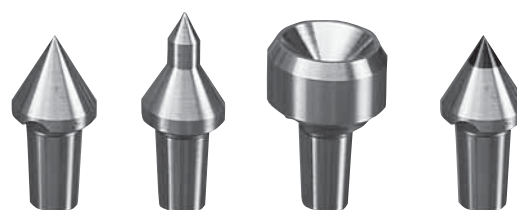

CON METALLO DURO (With hard metal)

Art. / Code	Fig.	E	S	G	F	Punta / Center
172.301 HM	4	14	16	6	-	60°

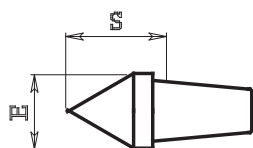

Fig. 1

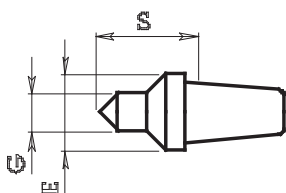

Fig. 2

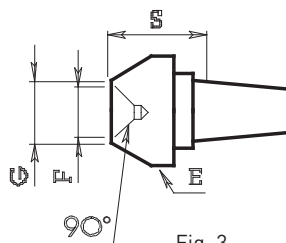

Fig. 3

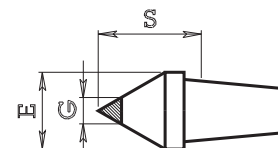
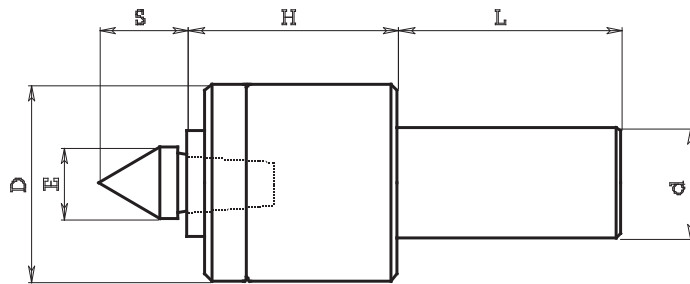

Fig. 4

CONTROPUNTA ROTANTE Tipo 172600 F
 REVOLVING TAILSTOCK

 Senza compressione
 (Without compression)

ATTACCO CILINDRICO (Cylindrical fitting)

Art. / Code	d	D	E	H	L	S
172.419 F	19.05	43	18	43	46	21
172.420 F	20	43	18	43	46	21
172.422 F	22	43	18	43	46	21
172.425 F	25	43	18	43	46	21
172.426 F	25.40	43	18	43	46	21
172.430 F	30	43	18	43	46	21
172.431 F	31.75	43	18	43	46	21
172.432 F	32	43	18	43	46	21

ATTACCO CONO MORSE (Morse taper fitting)

Art. / Code	d	D	E	H	L	S
172.400 F CM2	C.M.2	43	18	43	69	21
172.400 F CM3	C.M.3	43	18	43	85	21

 La contropunta viene fornita con cuspidi art. 172.401 (salvo diversa richiesta)
 The revolving tailstock is provided with code 172.401 (interchangeable insert)

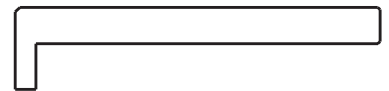
CHIAVI PER ESTRAZIONE
CUSPIDI ART. 172.411
 PULLER CODE 172.411

CONTROPUNTA ROTANTE CON COMPRESSIONE Tipo 172600
 REVOLVING TAILSTOCK WITH COMPRESSION

Per articolo (for Code): 172.400

Art. / Code	Fig.	E	S	G	Punta / Center
172.401	1	18	21	—	60°
172.401 090	1	18	28	—	90°
172.402	2	18	27	7	60°
172.402B	2	18	38	9	60°
172.403	3	30	21	14	60°
172.404	4	26	20	20	—

CON METALLO DURO (With hard metal)

Art. / Code	Fig.	E	S	G	Punta / Center
172.401 HM	5	18	21	6	60°

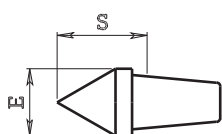

Fig. 1

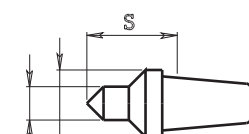

Fig. 2

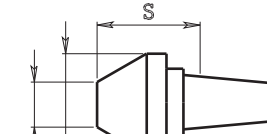

Fig. 3

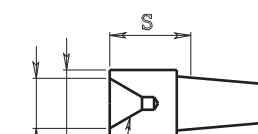

Fig. 4

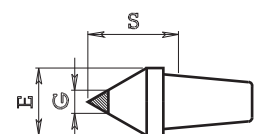
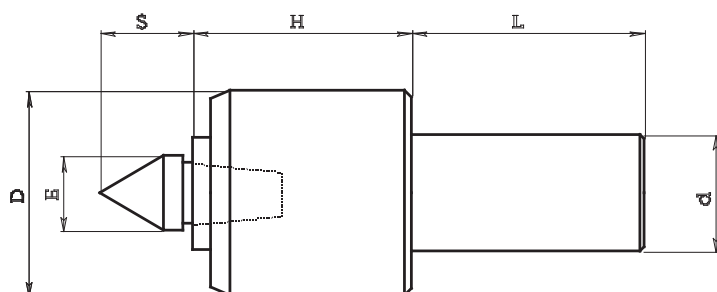

Fig. 5

CONTROPUNTA ROTANTE Tipo 172600 F

REVOLVING TAILSTOCK



ATTACCO CILINDRICO (Cylindrical fitting)

Art. / Code	d	D	E	H	L	S
172.625 F	25	58	28	71	50	34
172.626 F	25.40	58	28	71	50	34
172.632 F	32	58	28	71	70	34
172.640 F	40	58	28	71	85	34

Senza compressione
(Without compression)

ATTACCO CONO MORSE (Morse taper fitting)

Art. / Code	d	D	E	H	L	S
172.600 F CM3	C.M.3	58	28	71	85	34
172.600 F CM4	C.M.4	58	28	71	109	34
172.600 F CM5	C.M.5	58	28	71	136	34

La contropunta viene fornita con cuspidi art. 172.601 (salvo diversa richiesta)

The revolving tailstock is provided with code 172.601 (interchangeable insert)

CUSPIDI INTERCAMBIABILI PER CONTROPUNTA

INTERCHANGEABLE INSERT

Per articolo (for Code): 172.600

Art. / Code	Fig.	E	S	G	Punta / Center
172.601	1	28	34	—	60°
172.602	2	28	40	7	60°
172.602B	2	28	40	12	60°
172.603	3	58	36	25	60°
172.604	4	28	32	24	—



CON METALLO DURO (With hard metal)

Art. / Code	Fig.	E	S	G	Punta / Center
172.601 HM	5	28	34	10	60°

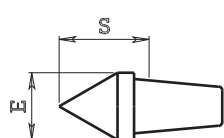

Fig. 1

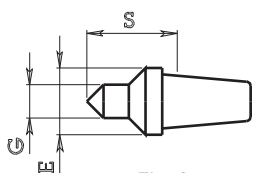

Fig. 2

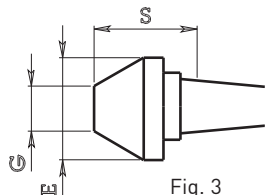

Fig. 3

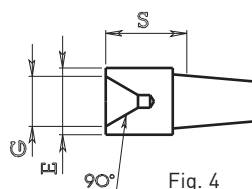

Fig. 4

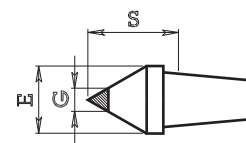
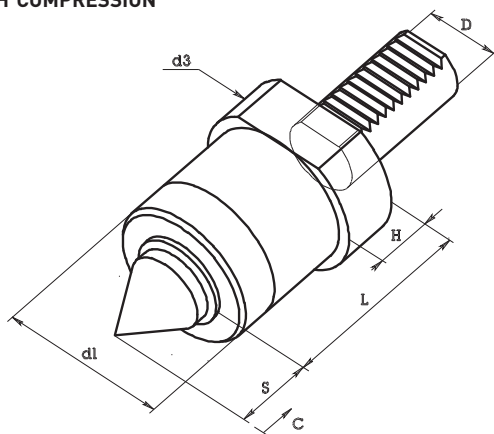

Fig. 5

CONTROPUNTA ROTANTE CON COMPRESIONE

REVOLVING TAILSTOCK WITH COMPRESSION



C = Corsa di compressione

C = Absorber stroke

Art. / Code	D	d1	d3	L	H	S	C
9 V3.30.78	30	58	68	78	20	34	2,5

9 V3.40.80	40	58	83	80	22	34	2,5
------------	----	----	----	----	----	----	-----

N.B. La contropunta viene fornita con cuspidi come Fig. 1 - Salvo diversa richiesta.

The revolving tailstock is provided with interchangeable insert Fig. 1.

CUSPIDI INTERCambiabili PER CONTROPUNTA

INTERCHANGEABLE INSERT

Art. / Code	Fig.	E	S	G
172.601	1	28	34	—
172.602	2	28	40	7
172.602 B	2	28	40	12
172.603	3	58	36	25
172.604	4	28	32	24

Con metallo duro (With hard metal)

Art. / Code	Fig.	E	S	G
172.601 HM	5	28	34	10

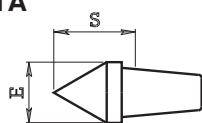

Fig. 1

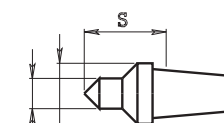

Fig. 2

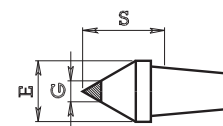

Fig. 5

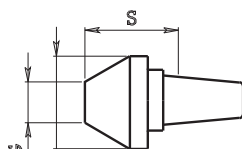

Fig. 3

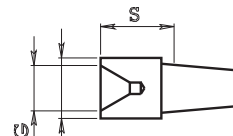

Fig. 4

CHIA-MO

WWW.CHIAMO.IT

I T A L Y



CHIA-MO srl

Via Caduti di Sabbiano, 12
40011 Anzola dell'Emilia (Bo) Italy
Tel. +39 051 734153 - Fax +39 051 734958
info@chiamo.it - www.chiamo.it

